

ORTHODONTIC

Product Catalogue

- for aesthetics and biocompatibility -



GESTENCO

Made by Sweden

THE COMPANY

goals and visions

Gestenco International AB has over the years developed and produced a variety of aesthetic orthodontic appliance systems. Several independent in vitro and in vivo university studies have verified our products to be among the best of its kind in the marketplace today. Subsequently, they have been very well received and used for many years by doctors all over the world.

We believe that our appliances have a great advantage to other materials particularly when it comes to things like:

- Aesthetics
- Biocompatibility
- Non-allergic
- Less pain to the patient
- No damage to enamel
- Easy bonding and debonding
- No discoloration
- Very low friction
- Preventing rootresorption

Our products are “made by Sweden” where quality and design is the key to a successful treatment and happy doctors and patients.

TABLE OF CONTENTS

CABRIOLET	3
PHANTOM	5
VITRINE	7
IMAGE	9
SOLO	13
BLONDE	14
BLONDE RAINBOW	15
CITIZEN	17
CITIZEN WIRES	21
SMARTBOND SC	23
SMARTBOND LC	25
IMAGINATION	27
BITE-BUMPER	29
LIP & CHEEK RETRACTOR	30
RUBBER SOUL	31
FREDDY CERAMIC BUTTON	33
IMAGE BUCCAL TUBE	34
SUPPLIES	35



CABRIOLET™

the clear hybrid self-ligating ortho appliance



- Polymer snap-on door for easy and fast closing/ opening - also protects in trauma situations.
- Ceramic body for strength and secure bonding. – slim design with low profile.
- Centred T hook for elastics and fits all NiTi chains.
- Both passive and active.
- Stainless steel hinge.
- Metal insert for reduced wire- friction.
- Radius in base for easier de-bonding.
- FDI notation in base for easy identification.



Cabriolet™ Formula Roth*							
Type	Description	Torque	Ang.	M/D mm	.018	.022	
Centrals	Upper right	+12°	5°	3.3	CA-11-45	CA-11-55	
	left				CA-21-45	CA-21-55	
Laterals	Upper right	+8°	9°	3	CA-12-45	CA-12-55	
	left				CA-22-45	CA-22-55	
Cuspids w/hook	Upper right	-2°	9°	3	CA-13-45HK	CA-13-55HK	
	left				CA-23-45HK	CA-23-55HK	
Bicuspids w/hook	Upper right/left	-7°	0°	3	CA-14-45HK	CA-14-55HK	
Anteriors	Lower right/left	0	0°	3	CA-30-45	CA-30-55	
Cuspids w/hook	Lower right	-11	5°	3	CA-43-45HK	CA-43-55HK	
	left				CA-33-45HK	CA-33-55HK	
1st Bicuspids	Lower right/left	-17	0°	3	CA-44-45	CA-44-55	
2nd Bicuspids	Lower right left	-22°	0°	3.	CA-45-45	CA-45-55	

* Gestenco Int. does not imply authorization or endorsement by Dr. Roth.



Cap opener

A double ended instrument with one end specially designed to open the cap on the Cabriolet brackets, and the other end with a wire director and height gauge.

Cap Opener	
Description	Catalogue No.
Cap opener	CO-00-01



PHANTOM™

Transparent Lingual Direct Bonding Self-Ligating Bracket



”THE ÖRTENDAHL LINGUAL SYSTEM”

- Self-ligating
- Direct bonding with fixed placement-jig guarantees correct position
- Interactive in final stage
- Optional tubes on premolars
- Manufactured in a transparent special medical grade polymer
- Great patient comfort from protective closing door
- Ceramic body for strength and secure bonding.
- Metal insert

WHY A TRANSPARENT LINGUAL BRACKET?

- No dark shades from brackets visible through teeth
- Truly invisible – also on lowers

Phantom lingual bracket						
Type	Description	Torque	Ang.	M/D mm	.018	
Cent./ Lat. /Cusp.	Upper/lower Right/left	55°	0°	4.2	PH-10-46	
Bicuspid	Upper /lower Right/left	10°	0°	4.2	PH-20-46	
Tube	Upper/lower	10°	0°	3.5	PH-67-00	

Phantom lingual arch wires			
.016 NiTi	Upper	Lower	
Small	PH-NT-116S	PH-NT-216S	
Medium	PH-NT-116M	PH-NT-216M	
Large	PH-NT-116L	PH-NT-216L	
.016X.022 NiTi	Upper	Lower	
Small	PH-NT-1622S	PH-NT-2622S	
Medium	PH-NT-1622M	PH-NT-2622M	
Large	PH-NT-1622L	PH-NT-2622L	
.016x.022 TiMb	PH-TI-1622	PH-TI-2622	
.016x.022 SS	PH-SS-1622	PH-SS-2622	

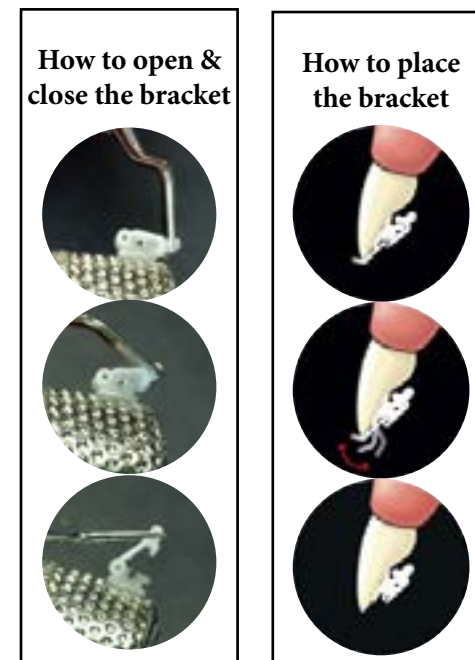

1. Put the placement-guide against the incisal edge for aligning and vertical distance
2. After bond set remove the guide by moving it back and forward 2-3 times
3. Open door for wire insertion with special instrument

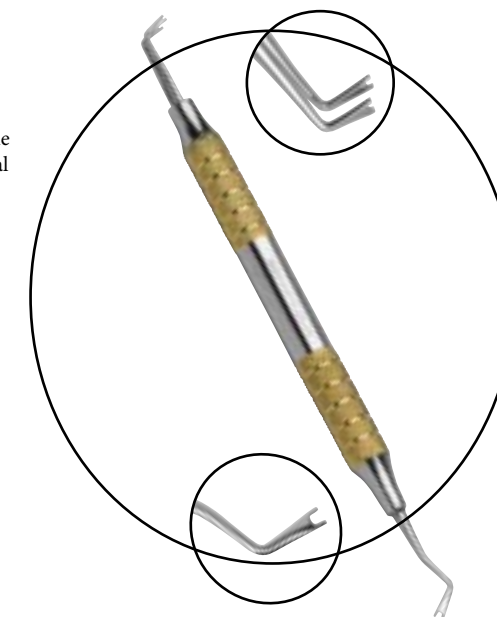

Phantom /Duett cap opener
PH-CO-01

Phantom Pearl chain	
Continuous	PC-00-01
Short	PC-00-02
Long	PC-00-03



Convenient starter kit Contents

- Brackets and tubes
- Selected wire sequence
- Special thin elastic chains
- Instrument for door opening and wire-placement
- Practise thimble



VITRINE 2.0™

Ceramic Brackets



Mechanical performance

- One-body manufacturing injection process solves the problem of brittleness and breakage and guarantees the precise slot.
- Undercut mesh in base enables optimal bonding strength and easy debonding.

Physical characteristics

- High breakage resistance and torque strength are achieved from the dense polycrystalline structure.
- Good biocompatibility, colour stability and no discolouration.

What patients will find ...

- Aesthetics
A more transparent and invisible appearance.
- Comfortable
Smooth surface, lower profile, smart hooks and perfect rounded facial contours enhance comfort.

What orthodontists will find ...

- Easy identification
Colour-mark on the gingival distal tie-wings identify the four quadrants.
- FDI notations in the base for accurate placement on the right tooth
- Accurate placement
Anatomically contour-compound base for fast and accurate fit.
- Available in Roth .022 / .018. MBT .022

Vitrine™ Formula Roth*					
Type	Description	Torque	Ang.	.018	.022
Centrals	Upper right	+12°	5°	VI-11-45	VI-11-55
	left			VI-21-45	VI-21-55
Laterals	Upper right	+8°	9°	VI-12-45	VI-12-55
	left			VI-22-45	VI-22-55
Cuspids w/hook	Upper right	-2°	11°	VI-13-45HK	VI-13-55HK
	left			VI-23-45HK	VI-23-55HK
Bicuspids	Upper right/left	-7°	0°	VI-14-45	VI-14-55
Bicuspids w/hook	Upper right	-7°	0°	VI-14-45HK	VI-14-55HK
	left			VI-24-45HK	VI-24-55HK
Anteriors	Lower right/left	-1°	2°	VI-30-45	VI-30-55
Cuspids w/hook	Lower right	-11°	5°	VI-43-45HK	VI-43-55HK
	left			VI-33-45HK	VI-33-55HK
1st Bicuspids	Lower right/left	-17°	0°	VI-44-45	VI-44-55
1st Bicuspids w/hook	Lower right	-17°	0°	VI-44-45HK	VI-44-55HK
	left			VI-34-45HK	VI-34-55HK
2nd Bicuspids	Lower right/left	-22°	0°	VI-45-45	VI-45-55
2nd Bicuspids w/hook	Lower right	-22°	0°	VI-45-45HK	VI-45-55HK
	left			VI-35-45HK	VI-35-55HK

* Gestenco Int. does not imply authorization or endorsement by Dr. Roth.

Vitrine™ MBT*-Style					
Type	Description	Torque	Ang.	.022	
Centrals	Upper right	+17°	4°	VI-11-52	VI-11-52
	left			VI-21-52	VI-21-52
Laterals	Upper right	+10°	8°	VI-12-52	VI-12-52
	left			VI-22-52	VI-22-52
Cuspids w/hook	Upper right	-7°	8°	VI-13-52HK	VI-13-52HK
	left			VI-23-52HK	VI-23-52HK
Bicuspids w/hook	Upper right	-7°	0°	VI-14-52HK	VI-14-52HK
	left			VI-24-52HK	VI-24-52HK
Anteriors	Lower right/left	-6°	0°	VI-30-52	VI-30-52
Cuspids w/hook	Lower right	-6°	3°	VI-43-52HK	VI-43-52HK
	left			VI-33-52HK	VI-33-52HK
1st Bicuspids w/hook	Lower right	-12°	2°	VI-44-52HK	VI-44-52HK
	left			VI-34-52HK	VI-34-52HK
2nd Bicuspids w/hook	Lower right	-17°	2°	VI-45-52HK	VI-45-52HK
	left			VI-35-52HK	VI-35-52HK

*MBT is a registered trademark by 3M/Unitek. Gestencos version of the McLaughlin, Bennett and Trevisi prescription is not intended to be a duplication of, nor an endorsement by these doctors and such endorsement is not implied by the use of this term.



IMAGE™

aesthetics in every case
and prescription



Image™ Standard Edgewise				
Type	Description	M/D mm	.018	.022
Centrals/Laterals	Upper right/left	3.5	IM-10-44	IM-10-54
Cuspids/Bicus-pids	Upper right/left	3.5	IM-20-44	IM-20-54
Anteriors	Lower right/left	2.6	IM-30-44	IM-30-54
Cuspids/Bicus-pids	Lower right/left	3.5	IM-40-44	IM-40-54

Image™ Formula Roth*							
Type	Description	Torque	Ang.	Offset	M/D mm	.018	.022
Centrals	Upper right left	+12°	5°	0°	3.5	IM-11-45 IM-21-45	IM-11-55 IM-21-55
Laterals	Upper right left	+8°	9°	0°	3.5	IM-12-45 IM-22-45	IM-12-55 IM-22-55
Cuspids	Upper right left	-2°	9°	4°M	3.5	IM-13-45 IM-23-45	IM-13-55 IM-23-55
Cuspids w/hook	Upper right left	-2°	9°	4°M	3.5	IM-13-45HK IM-23-45HK	IM-13-55HK IM-23-55HK
Bicuspids	Upper right/left	-7°	0°	0°	3.3	IM-14-45	IM-14-55
Bicuspids w/hook	Upper right/left	-7°	0°	0°	3.3	IM-14-45HK	IM-14-55HK
Anteriors	Lower right/left	0°	0°	0°	3.0	IM-30-45	IM-30-55
Cuspids	Lower right left	-11°	5°	2°M	3.5	IM-43-45 IM-33-45	IM-43-55 IM-33-55
Cuspids w/hook	Lower right left	-11°	5°	2°M	3.5	IM-43-45HK IM-33-45HK	IM-43-55HK IM-33-55HK
Bicuspids	Lower right/left	-17°	0°	0°	3.3	IM-44-45	IM-44-55

* Gestenco Int. does not imply authorization or endorsement by Dr. Roth.

THE PERFECT COMBINATION OF AESTHETICS AND CLINICAL PERFORMANCE

Image is made of a special grade polymer enforced with glassfiber, in order to reinforce the bracket to withstand all necessary orthodontic forces, without losing its flexibility.

GOOD LOOKS

Image stain-resistant material retains an aesthetic appearance throughout treatment. Upper and lower arches can confidentially be bonded, since enamel wear is virtually eliminated when in occlusion.

BONDING

Use your favourite bonding material, the mechanical lock base provides for easy and safe bonding, without the need for additional conditioners.

MARKING

A colour-coding system and placement jigs makes identification and alignment on the tooth real easy.

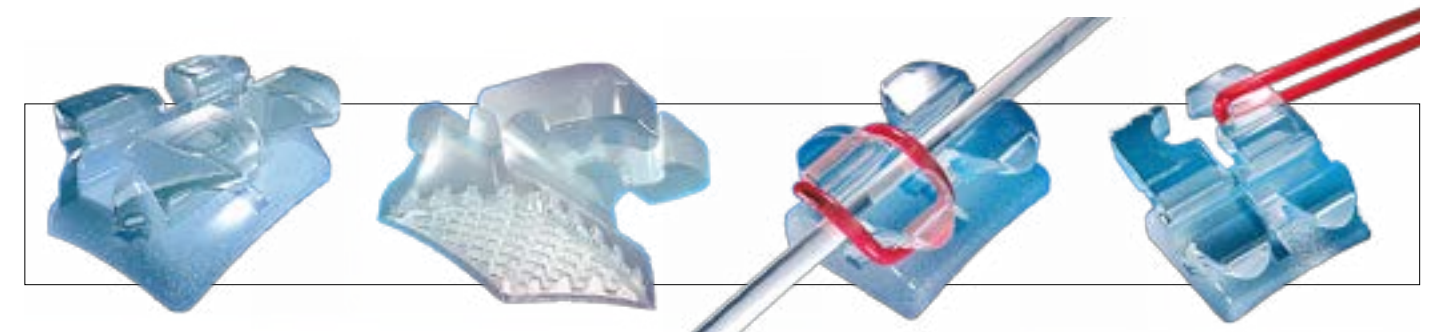

The relative ductility of the material combined with Image contoured compound curvature assures proven fit and bond-strength, without the concern of debonding complications.

The mechanical lock base on the Image bracket provides 150% more bonding surface.

The ability to tie one set of wings in the most severe malocclusions helps provide the necessary rotational control.

Double hook design for easy engagement of intraoral elastics.

IMAGE™

aesthetics in every case
and prescription



Image™ MBT*-Style					
Type	Description	Torque	Ang.	M/D mm	.022
Centrals	Upper right left	+17°	4°	3.5	IM-11-52 IM-21-52
Laterals	Upper right left	+10°	8°	3.5	IM-12-52 IM-22-52
Cuspids	Upper right left	-7°	8°	3.5	IM-13-52 IM-23-52
Cuspids w/hook	Upper right left	-7°	8°	3.5	IM-13-52HK IM-23-52HK
Bicuspid	Upper right/left	-7°	0°	3.3	IM-14-52
Bicuspid w/hook	Upper right/left	-7°	0°	3.3	IM-14-52HK
Anteriors	Lower right/left	-6°	0°	3.0	IM-30-52
Cuspids	Lower right left	-6°	3°	3.5	IM-43-52 IM-33-52
Cuspids w/hook	Lower right left	-6°	3°	3.5	IM-43-52HK IM-33-52HK
Bicuspid	Lower right/left	-17°	0°	3.3	IM-44-52

*MBT is a registered trademark by 3M/Unitek. Gestenco version of the McLaughlin, Bennett and Trevisi prescription is not intended to be a duplication of, nor an endorsement by these doctors and such endorsement is not implied by the use of this term.

Image™ Ricketts Bioprogressive*					
Type	Description	Torque	Ang.	M/D mm	.018
Centrals	Upper right left	+22°	0°	3.5	IM-11-47 IM-21-47
Laterals	Upper right left	+14°	8°	3.5	IM-12-47 IM-22-47
Cuspids	Upper right left	+7°	5°	3.5	IM-13-47 IM-23-47
Bicuspid	Upper right/left	0°	0°	3.3	IM-14-47
Anteriors	Lower right/left	0°	0°	3.0	IM-30-47
Cuspids	Lower right left	+7°	5°	3.5	IM-43-47 IM-33-47
Bicuspid	Lower right/left	0°	0°	3.5	IM-44-47

Image™ Formula Hilgers*					
Type	Description	Torque	Ang.	M/D mm	.018
Centrals	Upper right left	+22°	5°	3.5	IM-11-49 IM-21-49
Laterals	Upper right left	+14°	8°	3.5	IM-12-49 IM-22-49
Cuspids	Upper right left	+7°	5°	3.5	IM-13-49 IM-23-49
Bicuspid	Upper right/left	-7°	0°	3.3	IM-14-49
Anteriors	Lower right/left	0°	0°	3.0	IM-30-49
Cuspids	Lower right left	+7°	5°	3.5	IM-43-49 IM-33-49
1st Bicuspid	Lower right/left	-11°	0°	3.3	IM-44-49
2nd Bicuspid	Lower right/left	-17°	0°	3.3	IM-45-49

* Gestenco Int. does not imply authorization or endorsement by Dr. Hilgers and Rocky Mountain Orthodontics.

SOLO™

A bio-aesthetic single system

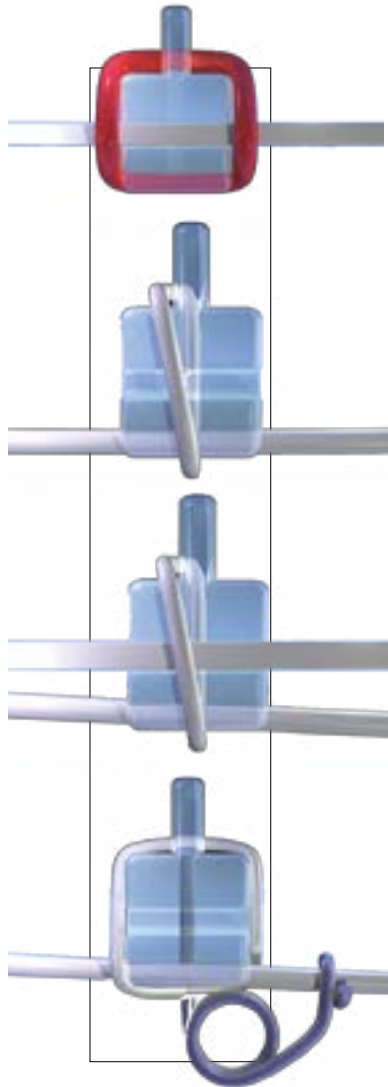

Solo is a glassfiber composite polymer bracket with archwire slots that makes it possible to combine tipping and translation. Efficiently applied minimum force will rapidly open bites and speed treatment. The gingival slot with its elliptical base makes tipping techniques very efficient. The archwire may be secured with pins, ligature ties, wire or springs. The vertical slot accepts auxiliaries for securing the archwire. Solo is available in the Roth prescription and Standard Edgewise, with .018 or .022 slots.

Solo™ Standard Edgewise				
Type	Description	M/D mm	.018	.022
Centrals/ Laterals	Upper right/left Lower right/left	2.6	SO-10-44	SO-10-54
Cuspids/ Bicuspid	Upper right/left Lower right/left	2.6	SO-20-44	SO-20-54

Solo™ Formula Roth*						
Type	Description	Torque	Ang.	M/D mm	.018	.022
Centrals	Upper right left	+12°	5°	2.6	SO-11-45 SO-21-45	SO-11-55 SO-21-55
Laterals	Upper right left	+8°	9°	2.6	SO-12-45 SO-22-45	SO-12-55 SO-22-55
Cuspids	Upper right left	-2°	9°	2.6	SO-13-45 SO-23-45	SO-13-55 SO-23-55
Bicuspid	Upper right/ left	-7°	0°	2.6	SO-14-45	SO-14-55
Anteriors	Lower right/ left	0°	0°	2.6	SO-30-45	SO-30-55
Cuspids	Lower right left	-11°	5°	2.6	SO-43-45 SO-33-45	SO-43-55 SO-33-55
Bicuspid	Lower right/ left	-17°	0°	2.6	SO-44-45	SO-44-55

* Gestenco Int. does not imply authorization or endorsement by Dr. Roth.

BLONDE™

Glass-reinforced composite polymer bracket

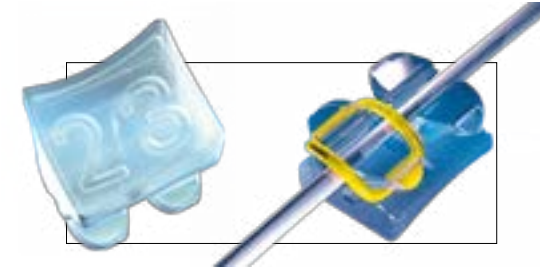

Blonde offers both the strength and the good looks that will give you and your patient great satisfaction. The Blonde bracket is available in Standard Edgewise .018 and .022, and in a complete and true "Straight-Arch" formula with:

- Ins and outs
- Torque in base
- Rhomboid shape for easy bracket placement
- Rotation and anti-rotation offsets
- Hooks available on cuspids/bicuspid
- Mechanical/chemical lock bonding base
- Each bracket is identified, according to the FDI system, with engraved numbers in the bracket base

Blonde™ Standard Edgewise				
Type	Description	M/D mm	.018	.022
Centrals/Laterals	Upper right/left	3.5	BL-10-44	BL-10-54
Cuspids/Bicuspid	Upper right/left	3.5	BL-20-44	BL-20-54
Anteriors	Lower right/left	2.6	BL-30-44	BL-30-54
Cuspids/Bicuspid	Lower right/left	3.5	BL-40-44	BL-40-54

Blonde™ Formula Roth*							
Type	Description	Torque	Ang.	Offset	M/D mm	.018	.022
Centrals	Upper right left	+12°	5°	0°	3.5	BL-11-45 BL-21-45	BL-11-55 BL-21-55
Laterals	Upper right left	+8°	9°	0°	3.5	BL-12-45 BL-22-45	BL-12-55 BL-22-55
Cuspids	Upper right left	-2°	9°	4°M	3.5	BL-13-45 BL-23-45	BL-13-55 BL-23-55
Cuspids w/ hook	Upper right left	-2°	9°	4°M	3.5	BL-13-45HK BL-23-45HK	BL-13-55HK BL-23-55HK
Bicuspid	Upper right/ left	-7°	0°	0°	3.3	BL-14-45	BL-14-55
Bicuspid w/ hook	Upper right/ left	-7°	0°	0°	3.3	BL-14-45HK	BL-14-55HK
Anteriors	Lower right/ left	0°	0°	0°	3.0	BL-30-45	BL-30-55
Cuspids	Lower right left	-11°	5°	2°M	3.5	BL-43-45 BL-33-45	BL-43-55 BL-33-55
Cuspids w/ hook	Lower right left	-11°	5°	2°M	3.5	BL-43-45HK BL-33-45HK	BL-43-55HK BL-33-55HK
Bicuspid	Lower right/ left	-17°	0°	0°	3.3	BL-44-45	BL-44-55

* Gestenco Int. does not imply authorization or endorsement by Dr. Roth.

BLONDE™

Rainbow edition



Put some colours into your patients smile with coloured blonde

Most young patients prefer coloured ligatures. Why not go all the way and offer them coloured brackets like the Blonde Rainbow Edition, a composite bracket in pink, blue, red and pearl violet.

BLONDE RAINBOW

- You don't need an assortment of coloured ligatures — only one transparent type will do.
- Goes particularly well with Imagination™, toothcoloured arch wires.
- Puts fashion into orthodontics — great patient motivator.
- For ordering add P, B, R or V to the Blonde part number ex. BL-11-45-P (for upper right central .018 Roth purple).

GLASS-REINFORCED COMPOSITE POLYMER BRACKET

Blonde offers both the strength and the good looks that will give you and your patient great satisfaction. The Blonde bracket is available in Standard Edgewise and in a complete and true "Straight-Arch" formula with:

- Ins and outs
- Torque in base
- Rhomboid shape for easy bracketplacement
- Rotation and anti-rotation offsets
- Hooks on cuspids U/L/bicuspid Upper
- Mechanical/chemical lock bonding base
- Each bracket is identified, according to the FDI system, with engraved numbers in the bracketbase

Blonde Rainbow formula Roth - Available in slot .018 and .022					
Type	Description	Torque	Ang	Offset	M/D mm
Centrals	Upper right/left	+12°	5°	0°	3,5
Laterals	Upper right/left	+8°	9°	0°	3,5
Cuspids w/hook	Upper right/left	-2°	9°	4°M	3,5
Bicuspid w/hook	Upper right/left	-7°	0°	0°	3,3
Anteriors	Lower right/left	0°	0°	0°	3
Cuspids w/hook	Lower right/left	-11°	5°	2°M	3,5
Bicuspid	Lower right/left	-17°	0°	0°	3,3

* Gestenco Int. does not imply authorization or endorsement by Dr. Roth.

Blonde Rainbow offers both the strength and the good looks that will give you and your patient great satisfaction.



CITIZEN™

medium and mini metal brackets

- Mini and Medium size
- Prescription Roth and MBT
- Slot .018 and .022
- Hooks on 3 or 3, 4, 5
- Lower profile design for least occlusal interference
- Deeper tie wings undercut for easy ligation
- Anatomically contoured mesh base for better bond strength and accurate fit.
- Rhomboidal shape
- ID mark by laser on the mesh base and colour coding on bracket wings
- 80 gauge mesh pad for an anatomically formed fit and maximum bonding strength
- For mini size add M to part number ex. CIM-11-45



Citizen™ Formula Roth* medium size					
Type	Description	Torque	Angulation	Roth .018	Roth .022
Centrals	Upper right	12°	5°	CI-11-45	CI-11-55
	left	12°	5°	CI-21-45	CI-21-55
Laterals	Upper right	8°	9°	CI-12-45	CI-12-55
	left	8°	9°	CI-22-45	CI-22-55
Cuspids	Upper right	-2°	11°	CI-13-45	CI-13-55
	left	-2°	11°	CI-23-45	CI-23-55
Cuspids w/hk	Upper right	-2°	11°	CI-13-45HK	CI-13-55HK
	left	-2°	11°	CI-23-45HK	CI-23-55HK
1 st Bicuspids	Upper right	-7°	0°	CI-14-45	CI-14-55
	left	-7°	0°	CI-24-45	CI-24-55
1 st Bicuspids w/hk	Upper right	-7°	0°	CI-14-45HK	CI-14-55HK
	left	-7°	0°	CI-24-45HK	CI-24-55HK
2 nd Bicuspids w/hk	Upper right	-7°	0°	CI-15-45	CI-15-55
	left	-7°	0°	CI-25-45	CI-25-55
2 nd Bicuspids w/hk	Upper right	-7°	0°	CI-15-45HK	CI-15-55HK
	left	-7°	0°	CI-25-45HK	CI-25-55HK
1 st Anteriors	Lower right	-1°	2°	CI-41-45	CI-41-55
	left	-1°	2°	CI-31-45	CI-31-55
2 nd Anteriors	Lower right	-1°	2°	CI-42-45	CI-42-55
	left	-1°	2°	CI-32-45	CI-32-55
Cuspids	Lower right	-11°	5°	CI-43-45	CI-43-55
	left	-11°	5°	CI-33-45	CI-33-55
Cuspids w/hk	Lower right	-11°	5°	CI-43-45HK	CI-43-55HK
	left	-11°	5°	CI-33-45HK	CI-33-55HK
1 st Bicuspids	Lower right	-17°	0°	CI-44-45	CI-44-55
	left	-17°	0°	CI-34-45	CI-34-55
1 st Bicuspids w/hk	Lower right	-17°	0°	CI-44-45HK	CI-44-55HK
	left	-17°	0°	CI-34-45HK	CI-34-55HK
2 nd Bicuspids	Lower right	-22°	0°	CI-45-45	CI-45-55
	left	-22°	0°	CI-35-45	CI-35-55
2 nd Bicuspids	Lower right	-22°	0°	CI-45-45HK	CI-45-55HK
	left	-22°	0°	CI-35-45HK	CI-35-55HK

Citizen™ Formula MBT* medium size					
Type	Description	Torque	Angulation	MBT .018	MBT .022
Centrals	Upper right	17°	4°	CI-11-42	CI-11-52
	left	17°	4°	CI-21-42	CI-21-52
Laterals	Upper right	10°	8°	CI-12-42	CI-12-52
	left	10°	8°	CI-22-42	CI-22-52
Cuspids	Upper right	-7°	8°	CI-13-42	CI-13-52
	left	-7°	8°	CI-23-42	CI-23-52
Cuspids w/hk	Upper right	0°	0°	CI-13-42HK	CI-13-52HK
	left	0°	0°	CI-23-42HK	CI-23-52HK
1 st Bicuspids	Upper right	-7°	0°	CI-14-42	CI-14-52
	left	-7°	0°	CI-24-42	CI-24-52
1 st Bicuspids w/hk	Upper right	-7°	0°	CI-14-42HK	CI-14-52HK
	left	-7°	0°	CI-24-42HK	CI-24-52HK
2 nd Bicuspids	Upper right	-7°	0°	CI-15-42	CI-15-52
	left	-7°	0°	CI-25-42	CI-25-52
2 nd Bicuspids w/hk	Upper right	-7°	0°	CI-15-42HK	CI-15-52HK
	left	-7°	0°	CI-25-42HK	CI-25-52HK
1 st Anteriors	Lower right	-6°	0°	CI-41-42	CI-41-52
	left	-6°	0°	CI-31-42	CI-31-52
2 nd Anteriors	Lower right	-6°	0°	CI-42-42	CI-42-52
	left	-6°	0°	CI-32-42	CI-32-52
Cuspids	Lower right	-6°	3°	CI-43-42	CI-43-52
	left	-6°	3°	CI-33-42	CI-33-52
Cuspids w/hk	Lower right	0°	3°	CI-43-42HK	CI-43-52HK
	left	0°	3°	CI-33-42HK	CI-33-52HK
1 st Bicuspids	Lower right	-12°	2°	CI-44-42	CI-44-52
	left	-12°	2°	CI-34-42	CI-34-52
1 st Bicuspids w/hk	Lower right	-12°	2°	CI-44-42HK	CI-44-52HK
	left	-12°	2°	CI-34-42HK	CI-34-52HK
2 nd Bicuspids	Lower right	-17°	2°	CI-45-42	CI-45-52
	left	-17°	2°	CI-35-42	CI-35-52
2 nd Bicuspids	Lower right	-17°	2°	CI-45-42HK	CI-45-52HK
	left	-17°	2°	CI-35-42HK	CI-35-52HK

New Citizen Vogue edition



CITIZEN™

metal buccal tubes

What orthodontists will find..

- Trumpet entry for fast guiding of the arch wire
- Color code and base laser mark makes it easy to identify
- Positioning notch to assist with placement
- Rounded ball hook design offer maximum comfort.
- 80 gauge mesh pad for an anatomically formed fit and maximum bonding strength
- Metal injection molding (MIM) for low friction and precise accuracy

What patients will find..

- Maximum comfort due to the low profile, rounded edge ballhook
- Minimal irritation due to smooth design with no sharp edges.
- Excellent biocompatibility from highly corrosion resistant stainless steel



Convertible buccal tubes

Citizen™ Tube Formula Roth*

Description	Torque	Offset	Roth .022 convert	Roth .022 nonconvert
1 st molar, upper right	-9	7	CI-16-221	CI-16-222
left	-9	7	CI-26-221	CI-26-222
1 st molar, lower left	-30	7	CI-36-221	CI-36-222
right	-30	7	CI-46-221	CI-46-222
			Roth .018 convert	Roth .018 nonconvert
1 st molar, upper right	-9	7	CI-16-181	CI-16-182
left	-9	7	CI-26-181	CI-26-182
1 st molar, lower left	-30	7	CI-36-181	CI-36-182
right	-30	7	CI-46-181	CI-46-182
				Roth .022 nonconvert
2 nd molar, upper right	-9	6	-	CI-17-222
left	-9	6	-	CI-27-222
2 nd molar, lower left	-30	6	-	CI-37-222
right	-30	6	-	CI-47-222
				Roth .018 nonconvert
2 nd molar, upper right	-9	6	-	CI-17-182
left	-9	6	-	CI-27-182
2 nd molar, lower left	-30	6	-	CI-37-182
right	-30	6	-	CI-47-182

Citizen™ Tube Formula MBT*

Description	Torque	Offset	MBT .022 convert	MBT .022 nonconvertw
1 st molar, upper right	-14	10	CI-16-223	CI-16-224
left	-14	10	CI-26-223	CI-26-224
1 st molar, lower left	-20	0	CI-36-223	CI-36-224
right	-20	0	CI-46-223	CI-46-224
			MBT .018 convert	MBT .018 nonconvert
1 st molar, upper right	-14	10	CI-16-183	CI-16-184
left	-14	10	CI-26-183	CI-26-184
1 st molar, lower left	-20	0	CI-36-183	CI-36-184
right	-20	0	CI-46-183	CI-46-184
				MBT .022 nonconvert
2 nd molar, upper right	-14	10	-	CI-17-224
left	-14	10	-	CI-27-224
2 nd molar, lower left	-10	0	-	CI-37-224
right	-10	0	-	CI-47-224
				MBT .018 nonconvert
2 nd molar, upper right	-14	10	-	CI-17-184
left	-14	10	-	CI-27-184
2 nd molar, lower left	-10	0	-	CI-37-184
right	-10	0	-	CI-47-184



Trumpet buccal tubes

CITIZEN™

arch wires MBT*-style

Recovery force Nickel titanium

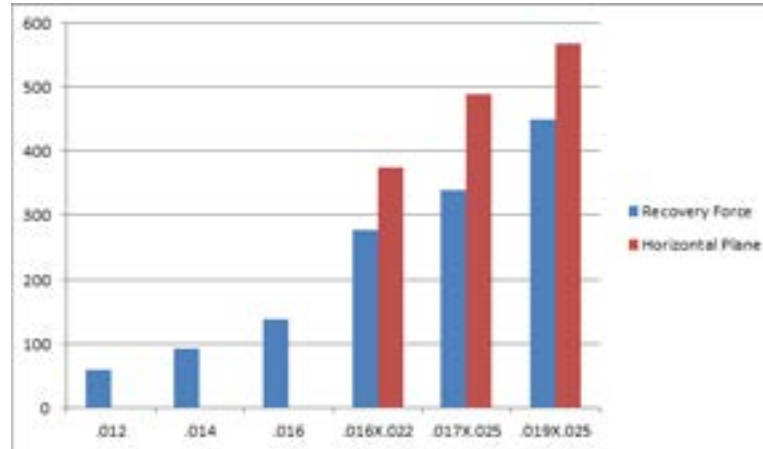

The Citizen Nickel Titanium is a uniquely enhanced alloy that has been exclusively formulated to yield consistent and specific force, memory, and elasticity values.

The clinically significant characteristics of Citizen Nickel Titanium include lower initial load forces, for patient comfort, and increased residual forces as full shape recovery progresses. Teeth move farther and faster.

By applying internationally recognized quality standards in our production processes, we can consistently deliver world class quality to our customers

The Stainless steel archwires are made by high quality 304v medical grade stainless steel.

By using only 304v medical grade stainless steel in conjunction with state-of-the-art wire forming equipment, we can ensure you a precise, high-quality stainless steel arch with consistent performance characteristics and integrity.

*MBT is a registered trademark by 3M/Unitek. Gestencos version of the McLaughlin, Bennett and Trevisi prescription is not intended to be a duplication of, nor an endorsement by these doctors and such endorsement is not implied by the use of this term.

Recovery Force Stainless Steel

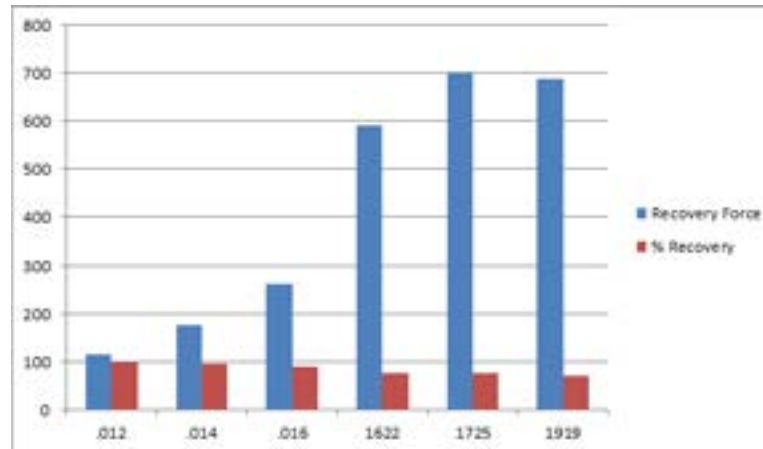

Citizen™ Nickel-Titanium (units of 10)		Stainless Steel (units of 10)		
Wire size	Upper	Lower	Upper	Lower
.012	CIW-NT-112	CIW-NT-212	CIW-SS-112	CIW-SS-212
.014	CIW-NT-114	CIW-NT-214	CIW-SS-114	CIW-SS-214
.016	CIW-NT-116	CIW-NT-216	CIW-SS-116	CIW-SS-216
.016X.022	CIW-NT-1622	CIW-NT-2622	CIW-SS-1622	CIW-SS-2622
.017X.025	CIW-NT-1725	CIW-NT-2725	CIW-SS-1725	CIW-SS-2725
.019X.025	CIW-NT-1925	CIW-NT-2925	CIW-SS-1925	CIW-SS-2925

Citizen™ Posted Stainless Steel (units of 10)		
Wire size		
.016X.022	22mm	CIW-PW-162222
.016X.022	24mm	CIW-PW-162224
.016X.022	26mm	CIW-PW-162226
.016X.022	28mm	CIW-PW-162228
.016X.022	30mm	CIW-PW-162230
.016X.022	32mm	CIW-PW-162232
.016X.022	34mm	CIW-PW-162234
.016X.022	36mm	CIW-PW-162236
.016X.022	38mm	CIW-PW-162238
.016X.022	40mm	CIW-PW-162240
.016X.022	42mm	CIW-PW-162242
.016X.022	44mm	CIW-PW-162244
.019X.025	22mm	CIW-PW-192522
.019X.025	24mm	CIW-PW-192524
.019X.025	26mm	CIW-PW-192526
.019X.025	28mm	CIW-PW-192528
.019X.025	30mm	CIW-PW-192530
.019X.025	32mm	CIW-PW-192532
.019X.025	34mm	CIW-PW-192534
.019X.025	36mm	CIW-PW-192536
.019X.025	38mm	CIW-PW-192538
.019X.025	40mm	CIW-PW-192540
.019X.025	42mm	CIW-PW-192542
.019X.025	44mm	CIW-PW-192544

Citizen™ Heat-NiTi Arch wire (units of 10)		
Wire size	Upper	Lower
.014	CIW-HNT-114	CIW-HNT-214
.016	CIW-HNT-116	CIW-HNT-216
.016X.022	CIW-HNT-1622	CIW-HNT-2622
.017X.025	CIW-HNT-1725	CIW-HNT-2725
.019X.019	CIW-HNT-1925	CIW-HNT-2925

Citizen™ TiMo Arch wire (units of 10)		
Wire size	Upper	Lower
.016	CIW-TIMO-116	CIW-TIMO-216
.016X.022	CIW-TIMO-1622	CIW-TIMO-2622
.017X.025	CIW-TIMO-1725	CIW-TIMO-2725
.018X.025	CIW-TIMO-1825	CIW-TIMO-2825

SMARTBOND SC[®]

The "superglue" in orthodontics and oral surgery



SmartBond is a completely new approach to bonding. A true one-step adhesive that allows you to bond brackets, buccal tubes and other attachments in a wet field, without the use of a light source or additional primers.

Other features:

- Biocompatible
- Allergy-tested

- Moisture activated
- Bonds on composite and porcelain surfaces
- No bad taste or smell for the patient
- No discolouration throughout treatment
- Bonds on plastic, metal and ceramic attachments
- Clinically proven efficiency for bonding of impacted canines

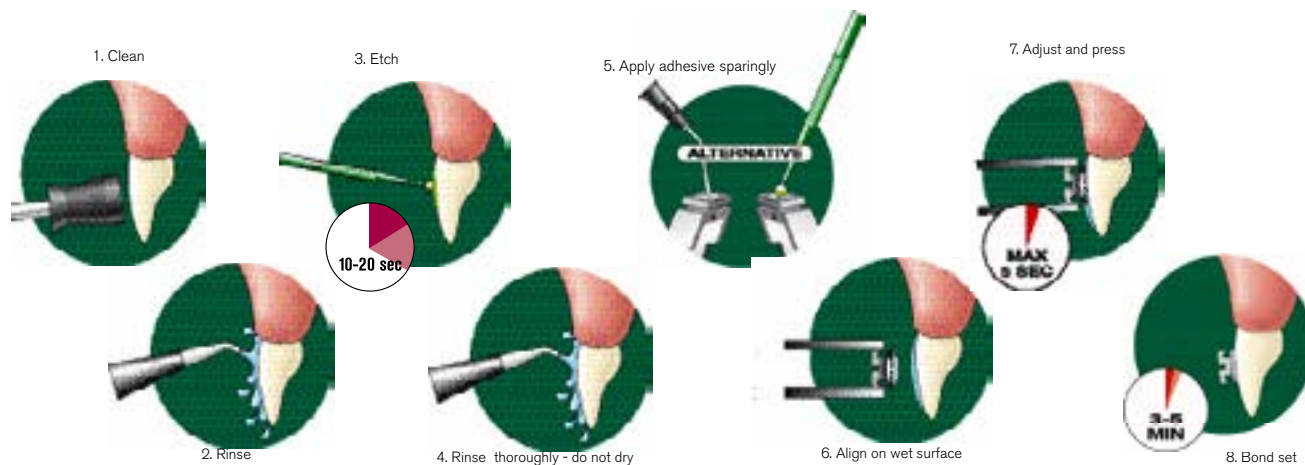

TRIAL KIT, SM-010



ECONOMY KIT, SM-001



SmartBond products	
Description	Catalogue No.
Trial-kit, 1g	SM-010
Mini-kit, 3g	SM-000
Economy kit, 6g	SM-001
Instant adhesive, 3g	SM-002
Etching gel, 6g	SM-003
Brushes, pkg of 50	SM-004
Luer-lock tips, pkg of 40	SM-005
Mixing pad	SM-006

SMARTBOND LC[®]

Light cure bonding adhesive



- For routine bonding 5 to 5
 - 1st and 2nd molar bonding
 - Exposed and high cuspid bonding
 - Works with water, saliva or blood
 - After etching, it's simply paste and light
 - No primers or conditioners that turns yellow after a while
- Bonds in a wet or dry field - your option
 - Dual-cure, light and/or selfcure
 - insures complete polymerization
 - fills any irregular pockets between base & enamel
 - Works with metal, plastic and ceramic brackets

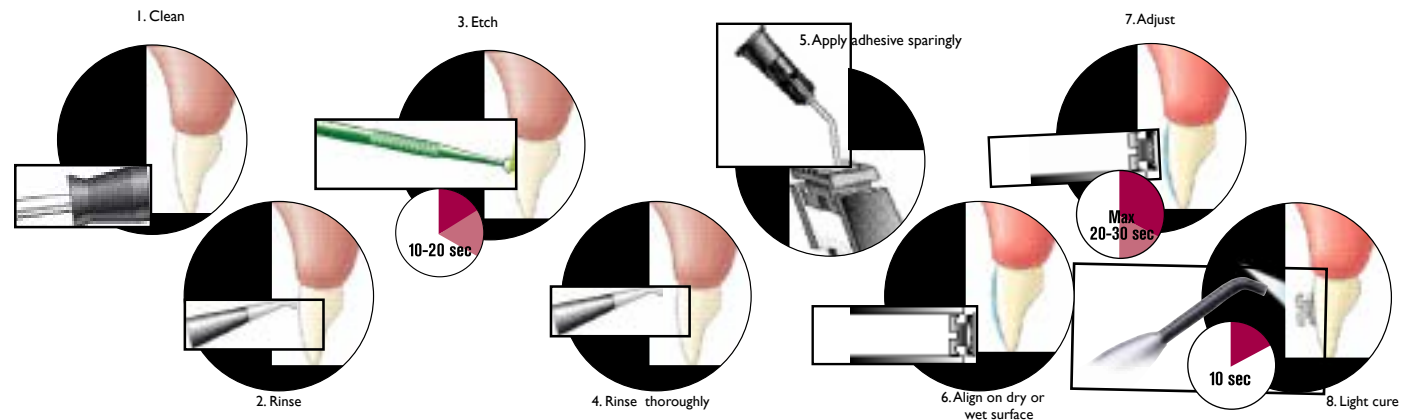

SmartBond LC products	
Description	Catalogue no.
Economy kit, 3g	SM-300-LC
Mini-kit, 1g	SM-100-LC
Etching gel, 6g	SM-003
Brushes, pkg of 50	SM-004
Flowthru tips, pkg of 30	SM-105-LC
Mixing pad	SM-006

SMARTBOND LC MINI-KIT
SM-100-LC



SMARTBOND LC ECONOMY KIT
SM-300-LC

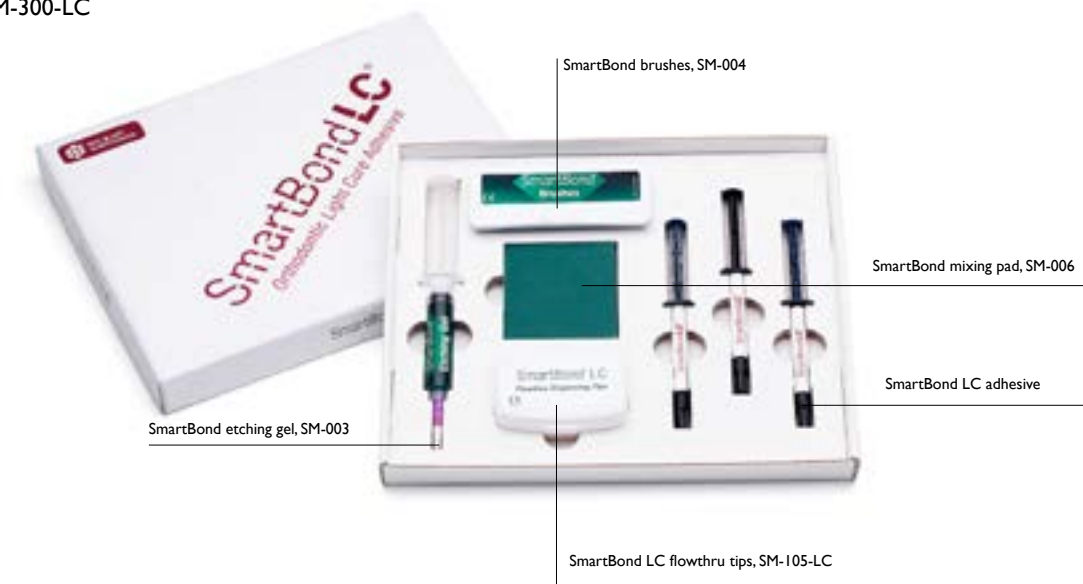

IMAGINATION™

tooth-coloured arch wires



Epoxy coated tooth-coloured arch wires with a NiTi (superelastic) or stainless steel core. They offer low friction when used with Image, Oyster ESL, Blonde and Solo, or any ceramic, metal or plastic bracket (see University reports on gestenco.com).

- Superior wear resistance and colour stability
- Retains superelastic qualities
- More natural looking than white coatings
- The only complete aesthetic wire range for a full treatment
- Available in Straight-wire and MBT*-style arch forms
- Also available with reverse curve of spee



Nickel-Titanium Reverse Curve (units of 10)		
Coated Wire Size	Upper	Lower
.012	IM-RC-112	IM-RC-212
.014	IM-RC-114	IM-RC-214
.016	IM-RC-116	IM-RC-216
.018	IM-RC-118	IM-RC-218
.020	IM-RC-120	IM-RC-220
.016x.022	IM-RC-1622	IM-RC-2622
.017x.025	IM-RC-1725	IM-RC-2725
.018x.018	IM-RC-1818	IM-RC-2818
.018x.025	IM-RC-1825	IM-RC-2825
.019x.025	IM-RC-1925	IM-RC-2925
.020x.020	IM-RC-2020	IM-RC-3020
.021x.025	IM-RC-2125	IM-RC-3125



The coating adds .002 inches to raw wire size



Straight-wire arch form

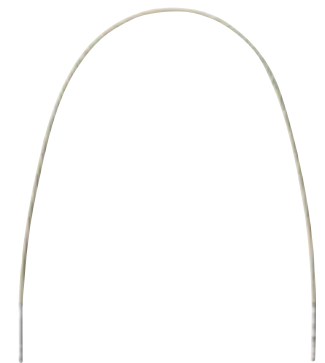

MBT*-style arch form

Straight-Wire Arch Form Nickel-Titanium (units of 10) Stainless Steel (units of 10)				
Coated Wire Size	Upper	Lower	Upper	Lower
.012	IM-NT-112	IM-NT-212	N/A	N/A
.014	IM-NT-114	IM-NT-214	IM-SS-114	IM-SS-214
.016	IM-NT-116	IM-NT-216	IM-SS-116	IM-SS-216
.018	IM-NT-118	IM-NT-218	IM-SS-118	IM-SS-218
.020	IM-NT-120	IM-NT-220	IM-SS-120	IM-SS-220
.016x.022	IM-NT-1622	IM-NT-2622	IM-SS-1622	IM-SS-2622
.017x.025	IM-NT-1725	IM-NT-2725	IM-SS-1725	IM-SS-2725
.018x.018	IM-NT-1818	IM-NT-2818	IM-SS-1818	IM-SS-2818
.018x.025	IM-NT-1825	IM-NT-2825	IM-SS-1825	IM-SS-2825
.019x.025	IM-NT-1925	IM-NT-2925	IM-SS-1925	IM-SS-2925
.020x.020	IM-NT-2020	IM-NT-3020	IM-SS-2020	IM-SS-3020
.021x.025	IM-NT-2125	IM-NT-3125	IM-SS-2125	IM-SS-3125

MBT*-Style Arch Form Nickel-Titanium (units of 10) Stainless Steel (units of 10)				
Coated Wire Size	Upper	Lower	Upper	Lower
.012	IM-NT-412	IM-NT-512	N/A	N/A
.014	IM-NT-414	IM-NT-514	IM-SS-414	IM-SS-514
.016	IM-NT-416	IM-NT-516	IM-SS-416	IM-SS-516
.018	IM-NT-418	IM-NT-518	IM-SS-418	IM-SS-518
.020	IM-NT-420	IM-NT-520	IM-SS-420	IM-SS-520
.016x.022	IM-NT-4622	IM-NT-5622	IM-SS-4622	IM-SS-5622
.017x.025	IM-NT-4725	IM-NT-5725	IM-SS-4725	IM-SS-5725
.018x.018	IM-NT-4818	IM-NT-5818	IM-SS-4818	IM-SS-5818
.018x.025	IM-NT-4825	IM-NT-5825	IM-SS-4825	IM-SS-5825
.019x.025	IM-NT-4925	IM-NT-5925	IM-SS-4925	IM-SS-5925
.020x.020	IM-NT-4020	IM-NT-5020	IM-SS-4020	IM-SS-5020
.021x.025	IM-NT-4125	IM-NT-5125	IM-SS-4125	IM-SS-5125

* MBT is a registered trademark by 3M/Unitek.



Coated ligature

Coated Ligatures	
Description	Catalog no.
.012	IM-CL-12

BITE-BUMPER™

open deep bite without trauma



Bite-Bumper™	
Description	Catalogue No.
Bite-Bumper (in packs of 10)	BB-00-01

Bite-Bumpers work in deep bite cases by allowing the anteriors to ride up and out of occlusion. The Bite-Bumpers eliminate bond failures of brackets and are especially valuable with ceramic or self-ligating brackets.

The unique fixed "placement-jig" guarantees the correct height on the lingual of the tooth and makes sure the two Bite-Bumpers are 100 % parallel.

The Bite-Bumpers are made of a composite polymer that is more comfortable, aesthetic and will increase biocompatibility in nickel sensitive patients.

Bite-Bumpers are bonded in the same manner as metal or ceramic brackets. The Bite-Bumpers have a slotted mechanical bonding base.

The placement-jig can easily be removed by hand or by a cutting instrument after bonding.

LIP-AND CHEEK RETRACTORS

Imagine Lip retractor	
Description	Catalogue No.
Adult size	LR-00-01
Child size	LR-00-02



Cheek Retractor	
Description	Catalogue No.
Cheek Retractor	CR-00-01



Evacu Cheek Retractor	
Description	Catalogue No.
Evacu Cheek Retractor	EV-00-01



Thomas Photo / Cheek Retractor	
Description	Catalogue No.
Thomas Cheek / photo Retractor	TR-00-01



RUBBER SOUL™

elastomerics

Elastomerics manufactured from the finest surgical grade natural latex rubber to ensure reliable force delivery.



Rubber Soul Latex	
Description	Catalogue No.
Latex 1/8 2,5oz	RS-LX-1825
Latex 1/8 4,5oz	RS-LX-1845
Latex 1/8 6,5oz	RS-LX-1865
Latex 3/16 2,5oz	RS-LX-31625
Latex 3/16 4,5oz	RS-LX-31645
Latex 3/16 6,5oz	RS-LX-31665
Latex 1/4 2,5oz	RS-LX-1425
Latex 1/4 4,5oz	RS-LX-1445
Latex 1/4 6,5oz	RS-LX-1465
Latex 5/16 2,5oz	RS-LX-51625
Latex 5/16 4,5oz	RS-LX-51645
Latex 5/16 6,5oz	RS-LX-51665
Latex 3/8 2,5oz	RS-LX-3825
Latex 3/8 4,5oz	RS-LX-3845
Latex 3/8 6,5oz	RS-LX-3865

Rubber Soul Sleeve*	
Description	Catalogue No.
Sleeve .025 grey	RS-ASG-027
Sleeve .025 clear	RS-ASC-027

Rubber Soul Thread*	
Description	Catalogue No.
Thread .025 grey	RS-TG-025
Thread .025 clear	RS-TC-25

*Latex free

Rubber Soul Separators*	
Description	Catalogue No.
Separators blue	RS-RES-00



Rubber Soul Ties*	
Description	Catalogue No.
Ties Clear	RS-CL-00
Ties metallic silver	RS-MS-00
Ties assorted neon	RS-AP-01
Ties assorted basic	RS-AP-02
Ties assorted multi	RS-AP-03

*Latex free



Assorted Basic



Assorted Neon



Assorted Multi

FREDDY™

ceramic button

The Freddy ceramic button* is the perfect clear utility button for all aesthetic appliances.

- Works lingual as well as labial
- The oral surgeons use them whenever clear appliances are indicated
- Mesh structure of base makes a strong bonding
- Bonds well with most common adhesives
- Anatomy and size of base fits all teeth
- Enough space around tie wing for all elastics
- Maintains the transparent look for aligners as anchorage for elastics

Freddy™ ceramic button	
Description	Catalogue No.
Ceramic buttons	FCB-00-01

*Patent pending



IMAGE™

buccal tube

BUCCAL TUBES

Glassfiber composite polymer bonding tube with torque-in-base for lower profile and reduced occlusal interference. Two types fits all molars, .018 and .022 archwire slots in the same attachment.

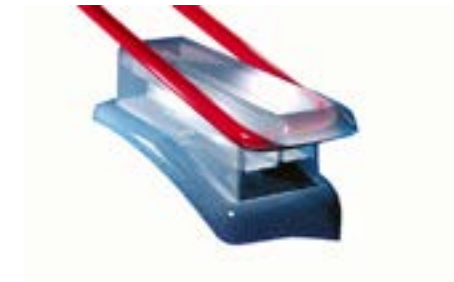

Buccal Tubes					
Description	Torque	Offset	M/D mm	.018	.022
Upper right/ lower left	-10°	7°D	7.0	IM-67-01	IM-67-01
Upper left/ lower right	-10°	7°D	7.0	IM-67-02	IM-67-02



SUPPLIES



Overbite Ruler	
Description	CatalogueNo.
Overbite ruler	OP-11-00



Coated Ligatures		
Description		CatalogueNo.
Coatedligatures	.012	IM-CL-12

CAP OPENER

A double ended instrument with one end specially designed to open the cap on the Cabriolet brackets, and the other end with a wire director and height gauge.

Cap Opener	
Description	Catalogue No.
Cap opener	CO-00-01



Phantom /Duett cap opener
PH-CO-01

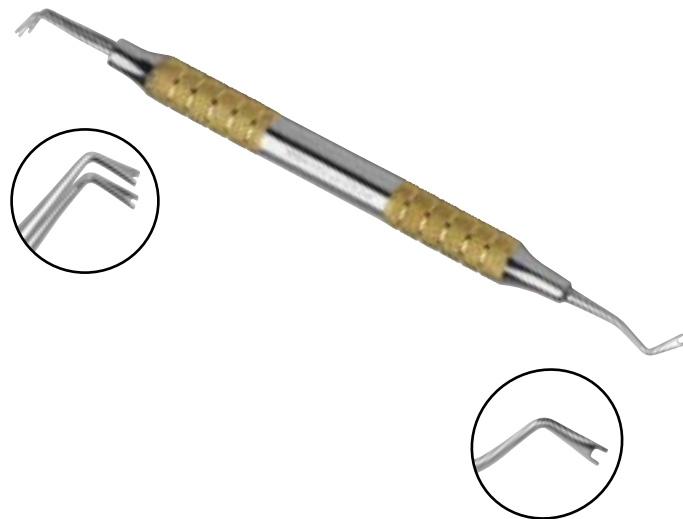

Moberg Arch Bender	
Description	CatalogueNo.
Arch Bender	MO-00-01



GESTENCO

Gestenco International AB
P O Box 24067, SE-400 22 Gothenburg, Sweden
Phone +46 31 81 00 35, Fax +46 31 81 46 55
www.gestenco.com / info@gestenco.com

ISO 9001 and
ISO 13485/CE certified